

**vtech**<sup>®</sup>

Parent's Guide

## Play & Go Puppy Salon



**VTech understands that a child's needs and abilities change as they grow and with that in mind we develop our toys to teach and entertain at just the right level...**

## **vtech** Baby

**Toys that will stimulate their interest in different textures, sounds and colours**

### **I am...**

...responding to colours, sounds and textures

...understanding cause and effect

...learning to touch, reach, grasp, sit-up, crawl and toddle

*Birth-36 months*



## **Pre-School**

**Interactive toys to develop their imagination and encourage language development**

### **I want...**

...to get ready for school by starting to learn the alphabet and counting

...my learning to be as fun, easy and exciting as can be

...to show my creativity with drawing and music so my whole brain develops

*3-6 years*



## **Electronic Learning Computers**

**Cool, aspirational and inspiring computers for curriculum related learning**

### **I need...**

...challenging activities that can keep pace with my growing mind

...intelligent technology that adapts to my level of learning

...National Curriculum based content to support what I'm learning at school

*4-10 years*



To learn more about this and other VTech® products, visit [www.vtech.co.uk](http://www.vtech.co.uk)

# INTRODUCTION

Thank you for purchasing the Play & Go Puppy Salon. Take this puppy carrier wherever you go, then open to reveal a pet grooming salon! Lights and sound effects enrich playtime as you pretend to wash, comb, dry and clip this soft pup. Learn about colours and puppy grooming as you play!

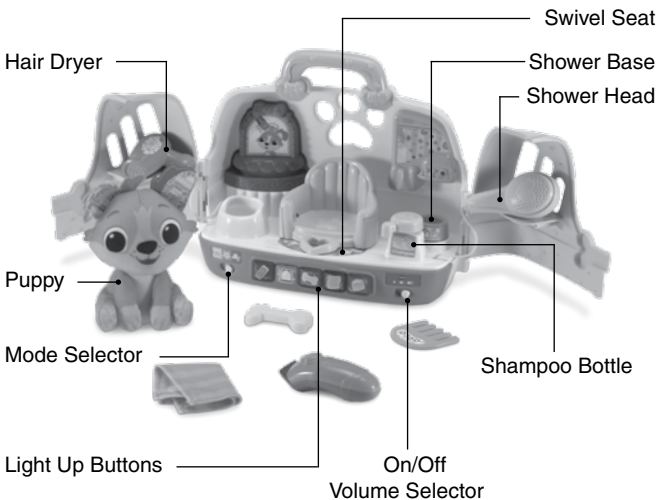

# INCLUDED IN THIS PACKAGE

- Play & Go Puppy Salon



- 1 puppy



- Puppy carrier/salon

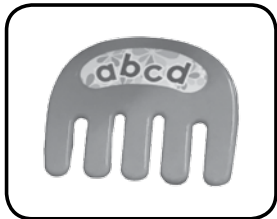

- 1 comb



- clippers



- 1 towel

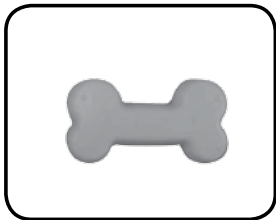

- 1 bone

- Parent's Guide

## NOTE

This toy is not intended for teething.

The infrared light sensors in the grooming set are sensitive to sunlight. The sensors may not perform properly in brightly lit, sunny rooms or under direct sunlight.

## WARNING

All packing materials such as tape, plastic sheets, packaging locks, removable tags, cable ties, cords and packaging screws are not part of this toy and should be discarded for your child's safety.

## NOTE

Please keep this Parent's Guide as it contains important information.

### Unlock the Packaging Locks

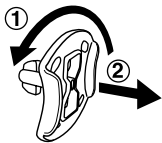

① Rotate the packaging locks 90 degrees anticlockwise.

② Pull out the packaging locks and discard.

## GETTING STARTED

### BATTERY REMOVAL AND INSTALLATION

1. Make sure the unit is turned OFF.
2. Find the battery cover located on the back of the unit. Use a coin or screwdriver to loosen the screw.
3. If used batteries are present, remove these batteries from the unit by pulling up on one end of each battery.
4. Install 2 new AA (AM-3/LR6) batteries following the diagram inside the battery box. (For best performance, alkaline batteries or fully charged Ni-MH rechargeable batteries are recommended).

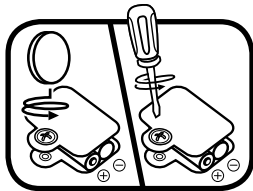

5. Replace the battery cover and tighten the screw to secure.

**WARNING:**

Adult assembly required for battery installation.

Keep batteries out of reach of children.

**IMPORTANT: BATTERY INFORMATION**

- Insert batteries with the correct polarity (+ and -).
- Do not mix old and new batteries.
- Do not mix alkaline, standard (carbon-zinc) or rechargeable batteries.
- Only batteries of the same or equivalent type as recommended are to be used.
- Do not short-circuit the supply terminals.
- Remove batteries during long periods of non-use.
- Remove exhausted batteries from the toy.
- Dispose of batteries safely. Do not dispose of batteries in fire.

**RECHARGEABLE BATTERIES:**

- Remove rechargeable batteries from the toy before charging.
- Rechargeable batteries are only to be charged under adult supervision.
- Do not charge non-rechargeable batteries.

## Disposal of batteries and product



The crossed-out wheellie bin symbols on products and batteries, or on their respective packaging, indicates they must not be disposed of in domestic waste as they contain substances that can be damaging to the environment and human health.



The chemical symbols Hg, Cd or Pb, where marked, indicate that the battery contains more than the specified value of mercury (Hg), cadmium (Cd) or lead (Pb) set out in the Batteries and Accumulators Regulation.

The solid bar indicates that the product was placed on the market after 13th August, 2005.

Help protect the environment by disposing of your product or batteries responsibly.

VTech® cares for the planet.

Care for the environment and give your toy a second life by disposing of it at a small electricals collection point so all its materials can be recycled.

In the UK:

Visit [www.recyclenow.com](http://www.recyclenow.com) to see a list of collection points near you.

In Australia & New Zealand:

Check with you local council for kerbside collections.

# PRODUCT FEATURES

## 1. On/Off/Volume Selector

Slide the **On/Off/Volume Selector** to the Low volume 🗣️ position or to the High volume 🗣️ position. Slide the selector to the **Off** position to turn the unit off.



## 2. Mode Selector

Slide the **Mode Selector** to learn about puppy grooming and more with Learning, Grooming Fun and Sounds & Music modes.



## 3. Light Up Buttons

Press the five **Light Up Buttons** to learn about colours, grooming and more.



## 4. Swivel Seat

Place **Puppy** on the **Swivel Seat** to hear fun responses. Swivel the seat to the left for the styling station 🗄️. Swivel the seat to the middle for the grooming station 🐾. Swivel the seat to the right for the wash station 🚿.





5. **Hair Dryer**

Pick up the **Hair Dryer** from the slot or put it back in the slot to hear fun sounds.

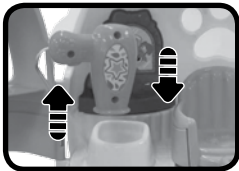

6. **Shampoo Bottle**

Press the **Shampoo Bottle** to learn about counting and hear fun sounds.



7. **Shower Base**

Press the **Shower Base** to hear fun sounds.



8. **Automatic Shut-Off**

To preserve battery life, the **Play & Go Puppy Salon** will automatically shut off after several minutes without input. The unit can be turned on again by sliding the **On/Off Volume Selector** to the Low or High volume position, or by sliding the **Mode Selector** to another mode.

**NOTE:**

If the unit powers down or if the lights fade during play, please install a new set of batteries.

# ACTIVITIES

## 1. Learning Mode

Press the five **Light Up Buttons** to learn about colours, grooming and more. Place **Puppy** on the **Swivel Seat** and swivel the seat to any location to hear fun phrases. Use the **Hair Dryer, Shampoo Bottle** and **Shower** to trigger phrases and lights.



## 2. Grooming Fun Mode

Press the five **Light Up Buttons, Shampoo Bottle, Shower Base** or remove the **Hair Dryer** from the slot to guide you through puppy grooming as you play. Place **Puppy** on the seat, then swivel the seat to any location to hear fun phrases.



## 3. Sounds & Music Mode

Press the five **Light Up Buttons** to hear melodies. Press the buttons again during the melodies to add fun sounds. Press the **Shampoo Bottle, Shower Base** or **Hair Dryer** to hear fun sounds. Place **Puppy** on the seat to hear **Puppy** sing a song or sing together with the melodies. Swivel the seat to trigger fun sounds with lights.



# SONG LYRICS

## Song 1

Wonderful tip-top salon,  
The hairdryer went on.  
The clippers cut,  
The comb felt great.  
Wonderful tip-top salon.

## Song 2

Here I go gloomy-groom.  
Here I go glammy-glam.  
Here I go glowy-glow.  
All at the puppy salon.

## Song 3

Scrub, scrub, scrub, wash and dry my furry hair.  
Brush my fur, and give me lots of care.  
When I am hungry, please give me yummy treats.  
We'll have lots of cuddles, this spa is so sweet!

# CARE & MAINTENANCE

1. Keep the unit clean by wiping it with a slightly damp cloth.
2. Keep the unit out of direct sunlight and away from any direct heat source.
3. Remove the batteries when the unit is not in use for an extended period of time.
4. Do not drop the unit on hard surfaces and do not expose the unit to moisture or water.

# TROUBLESHOOTING

If for some reason the unit stops working or malfunctions, please follow these steps:

1. Please turn the unit **OFF**.
2. Interrupt the power supply by removing the batteries.
3. Let the unit stand for a few minutes, then replace the batteries.
4. Turn the unit **ON**. The unit should now be ready to play again.
5. If the product still does not work, replace with a new set of batteries.

If the problem persists, please call our Consumer Services Department and a service representative will be happy to help you.

## CONSUMER SERVICES

Creating and developing VTech® products is accompanied by a responsibility that we at **VTech®** take very seriously. We make every effort to ensure the accuracy of the information, which forms the value of our products. However, errors sometimes can occur. It is important for you to know that we stand behind our products and encourage you to call our Consumer Services Department with any problems and/or suggestions that you might have. A service representative will be happy to help you.

UK Customers:

Phone: 0330 678 0149 (from UK) or +44 330 678 0149 (outside UK)

Website: [www.vtech.co.uk/support](http://www.vtech.co.uk/support)

Australian Customers:

Phone: 1800 862 155

Website: [support.vtech.com.au](http://support.vtech.com.au)

NZ Customers:

Phone: 0800 400 785

Website: [support.vtech.com.au](http://support.vtech.com.au)

# **Product Warranty/ Consumer Guarantees**

UK Customers:

Read our complete warranty policy online at [vtech.co.uk/warranty](http://vtech.co.uk/warranty).

Australian Customers:

## **VTECH ELECTRONICS (AUSTRALIA) PTY LIMITED – CONSUMER GUARANTEES**

Under the Australian Consumer Law, a number of consumer guarantees apply to goods and services supplied by VTech Electronics (Australia) Pty Limited. Please refer to [vtech.com.au/consumerguarantees](http://vtech.com.au/consumerguarantees) for further information.

**Visit our website for more  
information about our products,  
downloads, resources and more.**

***www.vtech.co.uk***  
***www.vtech.com.au***

